



85 | Interior trim luggage compartment CODE AX5X, BX5X

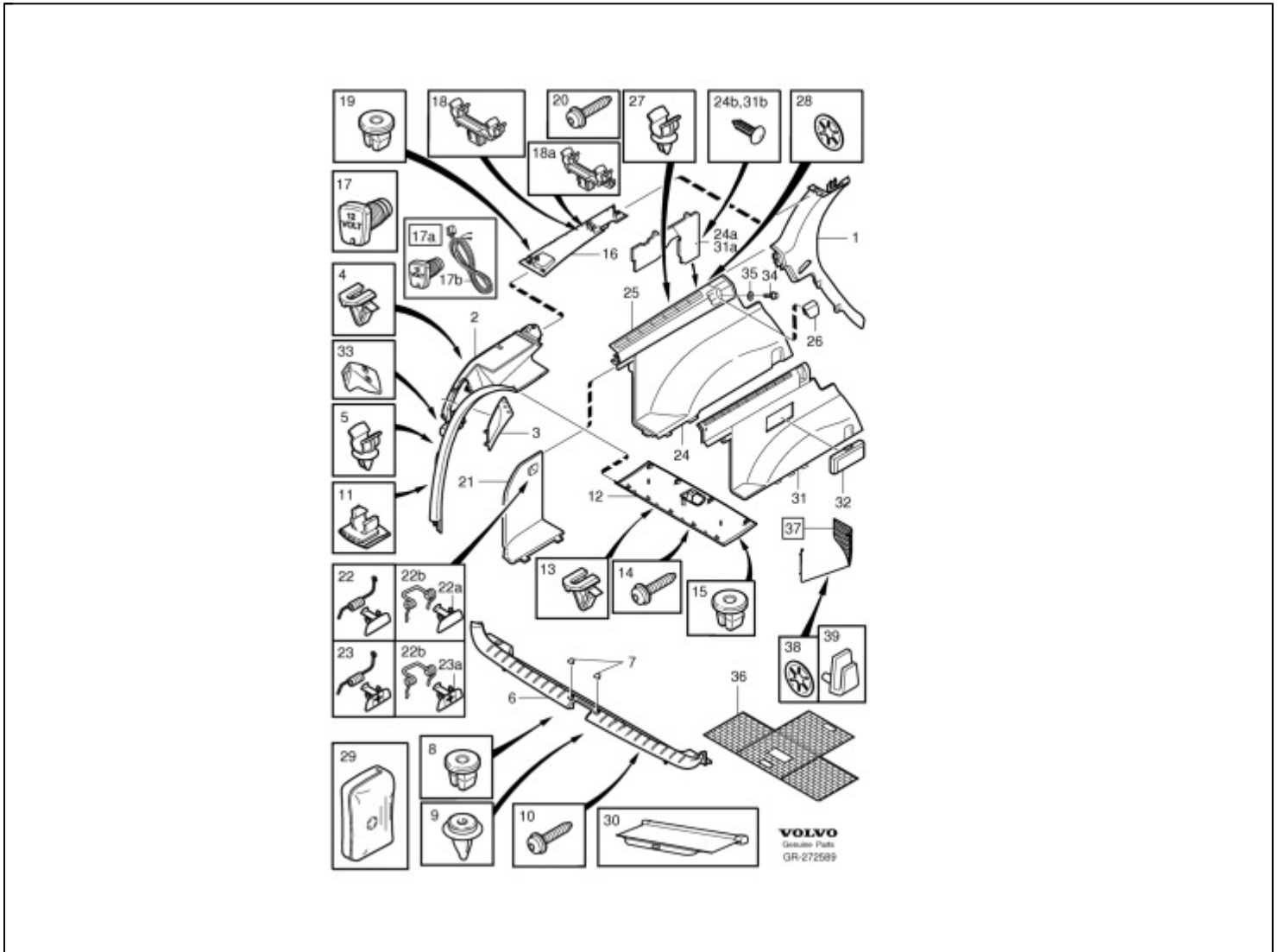

Fig.	Part No.	Description	Qty.	PS
1		Panel, C pillar Side panel passenger compartment and roof liner CODE AX5X, BX5X	1	
2	39980303	Panel, left, sand/beige, left	1	
	39967522	Panel, right, sand/beige, right	1	
3	9478437	Cover plate, left, sand/beige, left	1	
	9478443	Cover plate, right, sand/beige, right	1	
4	9132876	Clip	4	
5	9132544	Clip	2	
6	9478450	Sill moulding, sand/beige	1	
7	9478459	Plug, sand/beige	1	



8	1318908	Nut	2	
9	9193585	Clip	6	
10	986116	Six point socket screw	4	
	986498	Washer	4	
11	3539879	Clip	4	
12	39967516	Panel, sand/beige	1	
13	31389804	Clip	9	
14	986116	Six point socket screw	1	
	986498	Washer	1	
15	1318908	Nut	1	
16	39969531	Panel, left, sand/beige, left CH -424999 For vehicles without extra seat.	1	
	39890236	Panel, left, sand/beige, left CH 425000- For vehicles without extra seat.	1	
	39890239	Panel, right, sand/beige, right For vehicles without extra seat.	1	
	39890242	Panel, left, sand/beige, left Cars with extra seat.	1	
	39890245	Panel, right, sand/beige, right Cars with extra seat.	1	
17		Power outlet Switches	1	
17a	30737592	Power outlet CH 425000-	1	
17b	30724529	Wiring harness	1	
18	9164308	Clip	2	
18a	9494788	Clip	1	
19	1318908	Nut	2	
20	986116	Six point socket screw	2	
	986498	Washer	2	
21	39966514	Cover plate, left, sand/beige, left	1	
	39966522	Cover plate, left, sand/beige, left RTI, TAXI	1	
	39966519	Cover plate, right, sand/beige, right	1	
22	39966516	Lock handle, sand/beige FC1; CH -512179, FC 2; CH -511308	1	
22a	39966515	Lock handle, sand/beige FC1; CH 512180-, FC 2; CH 511309-	1	



22b	30740271	Spring FC1; CH 512180-, FC 2; CH 511309-	2	
23	39966528	Lock handle, with decal, sand/beige FC1; CH -505021, FC2; CH -503000	1	
23a	39966527	Lock handle, with decal, sand/beige FC1; CH 505022-, FC 2; CH 503001-	1	
24a		Insulating mat Insulating mats seals cabin	1	XX
24b	30653421	Clip	1	
24	39983726	Panel, left, sand/beige, left 1PCS 30653764, FC1; CH -447258, FC 2; CH -445650, 1PCS 30653421, REPL 1PCS 39894318-3 For cars without RTI/TV display. For vehicles without extra seat.	1	SP
	39894318	Panel, left, sand/beige, left FC1; CH 447259-, FC 2; CH 445651- For cars without RTI/TV display. For vehicles without extra seat.	1	
	9478052	Panel, left, sand/beige, left FC1; CH -472401, FC2; CH -471616, REPL 1PCS 39899313, 1PCS 30653764, 1PCS 30653421 For cars with RTI/TV display. For vehicles without extra seat.	1	SP
	39899313	Panel, left, sand/beige, left V70 FC 1; CH 472402-, FC 2; CH 471617- For cars with RTI/TV display. For vehicles without extra seat.	1	
	39983732	Panel, left, sand/beige, left REPL 1PCS 39894321-7, 1PCS 30653764, 1PCS 30653421, FC1; CH -447258, FC 2; CH -445650 Cars with extra seat. For cars without RTI/TV display.	1	
	39894321	Panel, left, sand/beige, left FC1; CH 447259-, FC 2; CH 445651- Cars with extra seat. For cars without RTI/TV display.	1	
	9478091	Panel, left, sand/beige, left FC1; CH -472401, FC2; CH -471616, REPL 1PCS 39899316, 1PCS 30653764, 1PCS 30653421 Cars with extra seat. For cars with RTI/TV display.	1	
	39899316	Panel, left, sand/beige, left V70 FC 1; CH 472402-, FC 2; CH 471617- Cars with extra seat. For cars with RTI/TV display.	1	
	39983765	Panel, right, sand/beige, right REPL 1PCS 39894330-8, 1PCS 30653763-0, 1PCS 30653421, FC1; CH -447258, FC 2; CH -445650 Marking for the electrical socket. For vehicles without extra seat.	1	SP



	39894330	Panel, right, sand/beige, right FC1; CH 447259-, FC 2; CH 445651- Marking for the electrical socket. For vehicles without extra seat.	1	
	39983759	Panel, right, sand/beige, right REPL 1PCS 39894336-5, 1PCS 30653763-0, 1PCS 30653421, FC1; CH -447258, FC 2; CH -445650 Cars with extra seat. Marking for the electrical socket.	1	
	39894336	Panel, right, sand/beige, right FC1; CH 447259-, FC 2; CH 445651- Cars with extra seat. Marking for the electrical socket.	1	
25	9478023	Panel, left, sand/beige, left See serviceinformation for installation instructions. For vehicles without extra seat.	1	
	9478071	Panel, left, sand/beige, left Cars with extra seat. See serviceinformation for installation instructions.	1	
	9478032	Panel, right, sand/beige, right See serviceinformation for installation instructions. For vehicles without extra seat.	1	
	9478084	Panel, right, sand/beige, right Cars with extra seat. See serviceinformation for installation instructions.	1	
26	9478055	Cap, left, sand/beige, left	1	
	9478058	Cap, right, sand/beige, right	1	
27	9132544	Clip, left	4	
	9132544	Clip, right	3	
28	987176	Retainer CH -675999	3	
	987176	Retainer CH 676000-	3	
29	31330988	First aid cushion EXC (BE), (DE), (LU), (NL)	1	
	31435624	First aid cushion (BE), (DE), (LU), (NL)	1	
30	9499026	Modesty panel, sand/beige	1	
31a		Insulating mat Insulating mats seals cabin	1	XX
31b	30653421	Clip	1	
31	39983738	Panel, left, sand/beige, left DVD, REPL 1PCS 39894324-1, 1PCS 30653421, 1PCS 30653764, FC1; CH -447258, FC 2; CH -445650 For vehicles without extra seat.	1	



	39894324	Panel, left, sand/beige, left DVD For vehicles without extra seat.	1	
	39983741	Panel, left, sand/beige, left REPL 1PCS 39894324-1, 1PCS 30653421, 1PCS 30653764, FC1; CH -447258, FC 2; CH -445650, DVD Cars with extra seat.	1	
	39894327	Panel, left, sand/beige, left FC1; CH 447259-, FC 2; CH 445651-, DVD Cars with extra seat.	1	
32	39970419	Hatch, sand/beige	1	
33	9481258	Anchorage, left	1	
	9481259	Anchorage, right	1	OP
34	986201	Six point socket screw	1	
35	986498	Washer	1	
36	30721781	Allround box, complete	1	OP
37	30721717	Net pocket, beige	1	
38	987176	Retainer	3	
39	9476833	Clip, beige	3	