



XC90, 2006, B5254T2, YV4CZ592661252744, 252744

18/8/2010

PRINT

55: Brake controls, mechanical, L.H.D

Parking brake self-adjustment, resetting

Note! The illustrations in this service information are used for different model years and/or models. Some variation may occur. However, the essential information in the illustrations is always correct.

Removal

Removing soundproofing panels

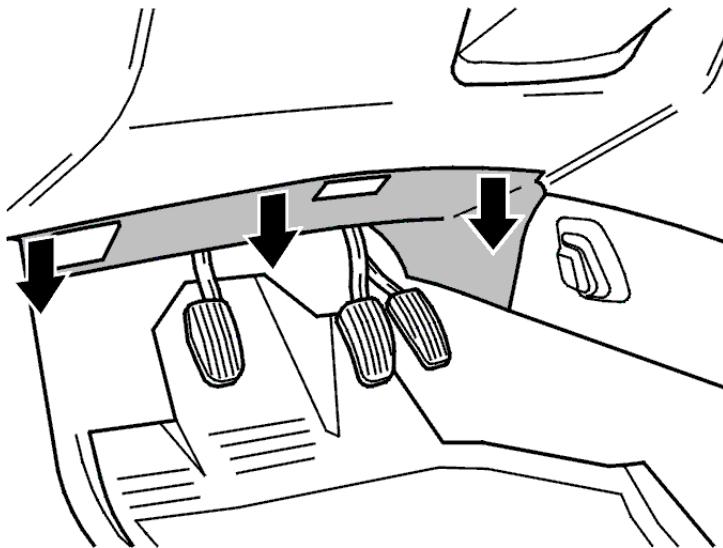

Hint:

The soundproofing panel sits in grooves at the pedal box.

Slacken off the 2 screws.
Pull the soundproofing panel straight down at the dashboard.
Then pull the soundproofing panel backwards. Lift out the soundproofing panel.

Removing the OBDII bracket

Remove the 2 screws.
Allow the bracket to hang from the wiring

Removing the relay box

Insert a screwdriver between the bracket and the relay box. Turn the

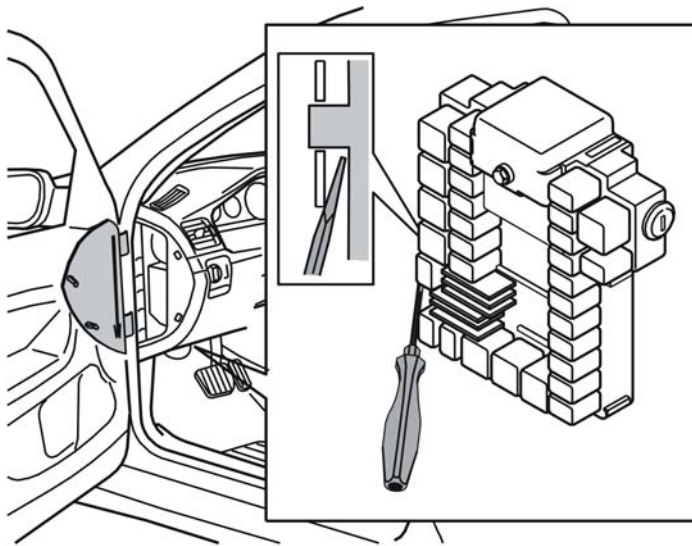

screwdriver so that the bracket opens out. At the same time, pull the relay box out of the bracket towards the underside of the dashboard. Lift the relay box off the bracket. Pull the relay box downward under the dashboard.

Removing the parking brake pedal

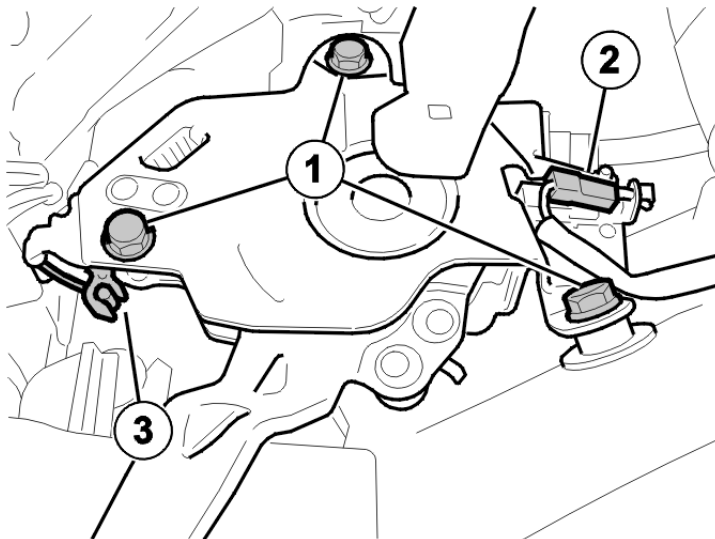

Remove:

- the pedal (1) from the body, 3 screws, and pull/turn it diagonally backwards/inwards
- the wiring (2) for the pedal switch
- the disengagement cable (3) for the pedal.

Reset the parking brake to the zero position

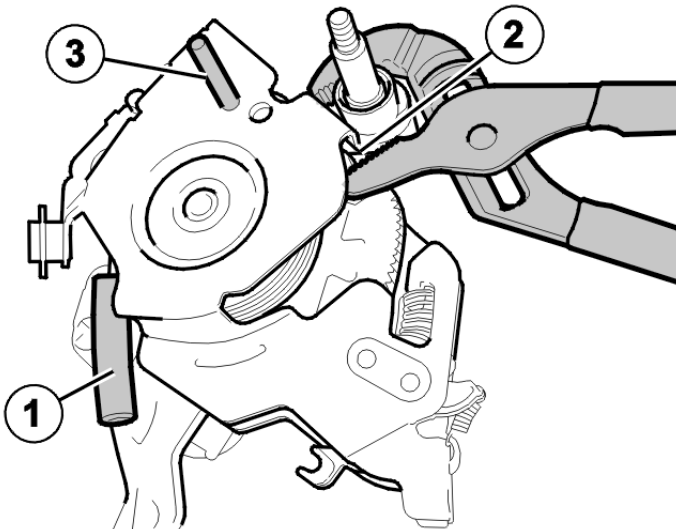

Install a hose with an inner diameter of **5 mm** on the end of the friction spring (1). Open the friction spring so that the primary cable runs freely. Use a pipe wrench to push back the primary cable mounting (2). Insert a **6.5 mm** locking pin into the hole in the pedal (3) (it must pass through the bracket, cable pulley, pedal and the other bracket).

Installation

Note! For tightening torques, see: Tightening torque .

Resetting the parking brake

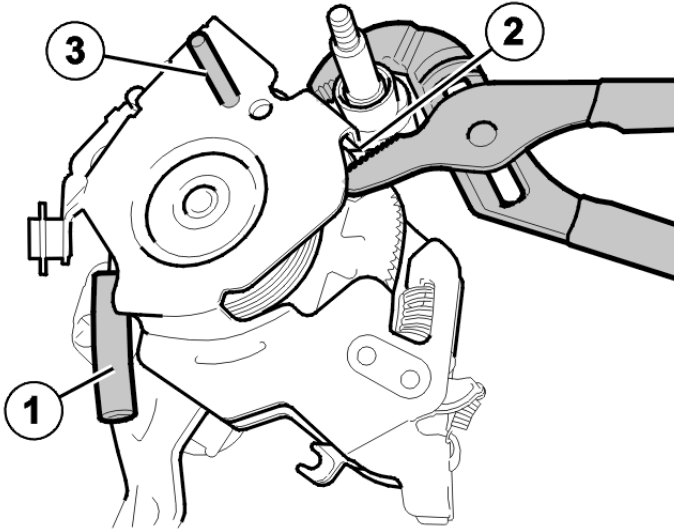

Press the primary cable mounting (2) back into place. Remove the locking pin (3). Reset the primary cable mounting to the operating position. Remove the hose from the friction spring (1).

Installing the parking brake pedal

Install:

- the disconnecting cable for the pedal
- the cables for the switch before the pedal has been turned in
- the parking brake pedal, 3 screws (M8).

Finishing

Check the function of the parking brake.

Press down and release the pedal 5 times.

Note! Only when replacing.

Press the pedal down so that the clip cracks

Installing the relay box in the passenger compartment

Install the relay box on the

bracket.

Press the relay box forward so that the catches engage in the bracket and “click”. Install the soundproofing panel using 2 screws.

Installing the OBDII bracket and soundproofing panel

Install:

- the OBDII bracket using the 2 screws
- the soundproofing panel using the 2 screws.

18/8/2010

PRINT